



HIGH-PERFORMANCE CYLINDER REGULATOR

FE300

ESAB FE300 is the reliable partner of each user in the welding workshop. It will never make the operator disappointed leaving him without a proper gas supply. By its performance, it covers the majority of all industrial gas applications with gas cylinder use. It protects the surrounding area by keeping it insulated from the high gas pressure and supplying only the wished amount of the gas at pressure adjusted by a user.

Variants with side entry, bottom entry, pressure gauges, and flow meter fulfill all the requested tasks.

Cylinder regulator FE300 is made in Europe.

It has been created to help make the production process safe and efficient.



FE300

PRODUCT FEATURES

- High-performance regulator following all common technical gas applications needs.
- Safety focused design following **ISO 2503**.
- **Prolonged lifetime** saving costs related to services, spares and replacements.
- Encapsulated regulating technology for precise and stable control.
- Easy handling for the operator by ergonomic arrangement.
- Side and Bottom entry design variants fit on all types of cylinder valves.
- Three scale pressure gauges acc. to ISO 5171 with high contrast pointer for better gas pressure clarity.
- Made in Europe.

TECHNICAL DATA

Gas	O ₂ , N ₂ , H ₂ , He	Ar, Ar/CO ₂	CO ₂	Acetylene	Propane
Body	Brass forged				
Bonnet	Zn/Al alloy Die Cast				
Stems, nuts and fittings	Brass				
Diaphragm	EPDM				NBR
Seat sealing	PA			CR	
Inlet/ Outlet connection	Gas specific connection				
Maximal inlet pressure	200 or 300 bar		200 bar	25 bar	
Outlet pressure/ flow range	0-10 bar	0-16l/min 0-30 l/min 0-40l/min		1,5 bar	4 bar
Temperature range	From -20°C to 60°C				
Weight	Approx. according to gas variant: 1,9 kg				

PRODUCT ADVANTAGES

Triple scale gauges

According to ISO 5171, with high contrast pointer for better gas pressure clarity.



Encapsulated regulating valve technology.

Encapsulated regulating technology for precise parameters and stability, tested for many years.

Accurate parameter setting with an optimized pressure adjusting mechanism.



Colour coded handwheel

Simple identification of the gas, ergonomic and robust design, easy handling for the operator.

Inlet connection

Side and bottom entry variants available, variants fit on all types of cylinder valves.

FE300

FLOW CHARTS

Oxygen 300/4 bar

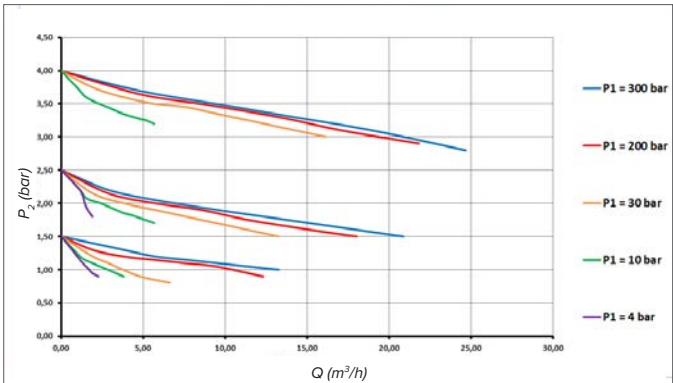

Acetylene 25/1,2 bar

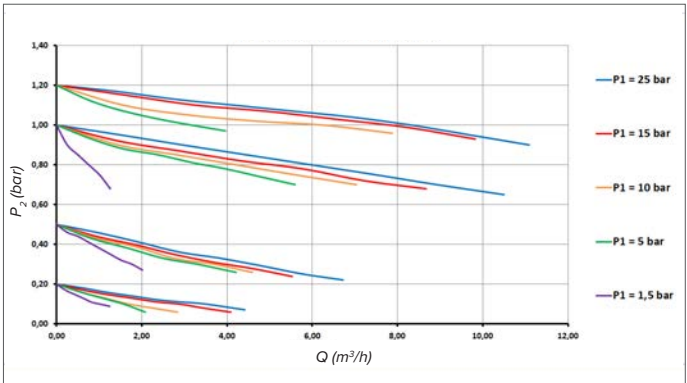

Compressed gases 300/10 bar (measured by air)

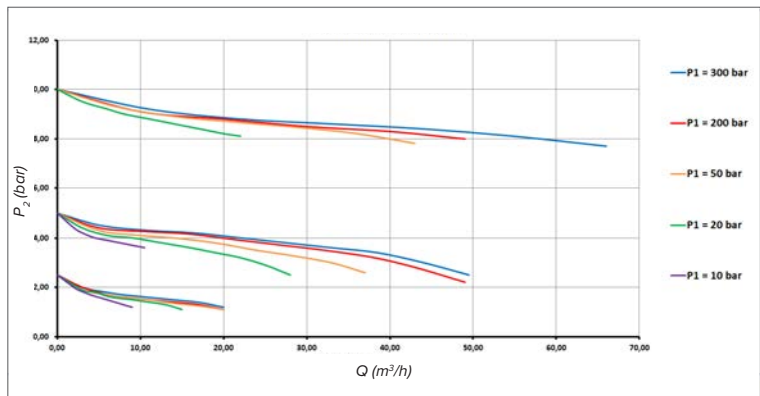

Propane 25/4 bar

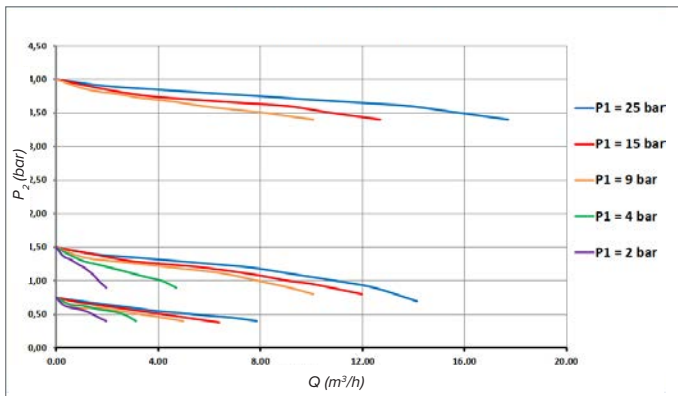

Conversion coefficient							
Test gas	Air	Oxygen	Nitrogen	Argon	Hydrogen	Helium	CO ₂
Air	1	0,950	1,02	0,851	3,81	2,695	0,808

Flow of the gas (A)

$$A=Q \cdot f$$

Q... Air Flow

f... Conversion coefficient

DIMENSIONS

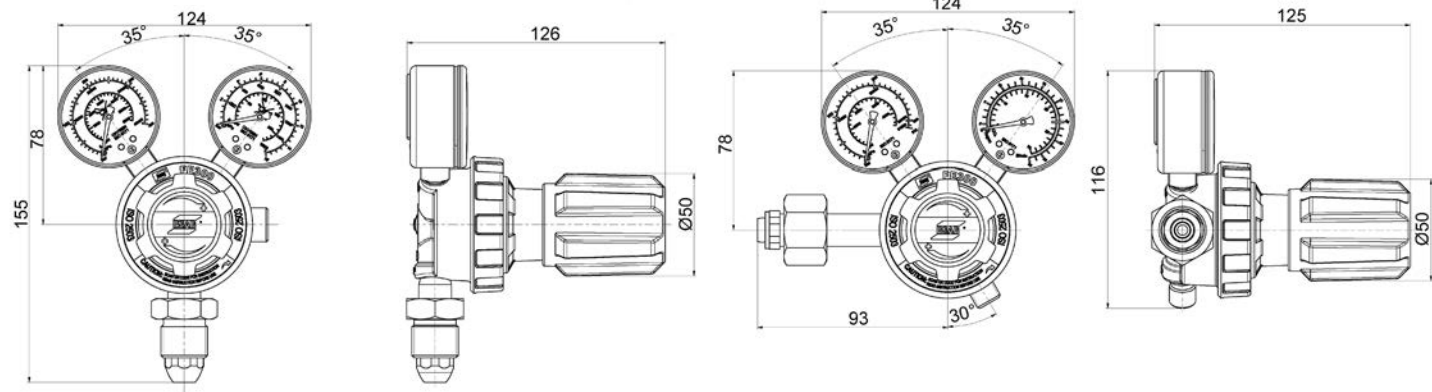

FE300

ORDERING INFORMATION

Part number	Gas	Inlet position	Inlet pressure	Outlet pressure	Inlet connection	Outlet connection	Type
FS0700017210	ACETYLENE	side	25 bar	1,5 bar	G5/8" LH BSP	G3/8" LH BSP	
FS0700017211	ACETYLENE	bottom	25 bar	1,5 bar	G5/8" LH BSP	G3/8" LH BSP	
FS0700017212	ACETYLENE	bottom	25 bar	1,5 bar	G5/8" LH BSP	G3/8" LH BSP	no gauge
FS0700017221	Ar/CO ₂	bottom	300 bar	0 - 40 l/min	G5/8" BSP	G3/8" BSP	
FS0700017222	Ar/CO ₂	side	300 bar	0 - 40 l/min	G5/8" BSP	G3/8" BSP	
FS0700017223	Ar/CO ₂	bottom	300 bar	4,5 bar preset	G5/8" BSP	G3/8" BSP	HP gauge only
FS0700017460	Ar/CO ₂	side	300 bar	4,5 bar preset	G5/8" BSP	G3/8" BSP	HP gauge only
FS0700018107	Ar/CO ₂	side	300 bar	0 - 40 l/min	NEVOC	G3/8" BSP	
FS0700018106	INERT	side	300 bar	10 bar	G5/8" BSP	G3/8" BSP	
FS0700017204	OXYGEN	side	300 bar	10 bar	G5/8" BSP	G3/8" BSP	
FS0700017205	OXYGEN	bottom	300 bar	10 bar	G5/8" BSP	G3/8" BSP	
FS0700017206	OXYGEN	bottom	300 bar	10 bar	G5/8" BSP	G3/8" BSP	LP gauge only
FS0700017459	OXYGEN	bottom	300 bar	4 bar	G5/8" BSP	G3/8" BSP	
FS0700017461	OXYGEN	side	300 bar	4 bar	G5/8" BSP	G3/8" BSP	
FS0700017458	PROPANE	side	25 bar	4 bar	G5/8" LH BSP	G3/8" LH BSP	LP gauge only
FS0700017213	PROPANE	side	25 bar	4 bar	G5/8" LH BSP	G3/8" LH BSP	no gauge



FS0700017213



FS0700017205



FS0700017222



FS0700017223

SPARE PARTS FLOWMETERS

Part number	Gas	Flow	Working pressure	Inlet connection	Outlet connection
FS0701300021	Ar/CO ₂	16 l/min	4,5 bar	G3/8"	G3/8"
FS0701300022	Ar/CO ₂	30 l/min	4,5 bar	G3/8"	G3/8"



FS0701300021



FS0701300022



FS0700017223
FS0701300022