



## NEW GENERATION OF RAIL CLAMPS

# MediClamp

EDITION 1/2016

Rail clamps are parts of rail systems and are intended for fastening the medical devices (flowmeters, suction equipment, lighting, etc.) to the railing.

Max. load at vertical axis - 50 kg.

### FEATURES AND BENEFITS

The MediClamp is universal and can be applied to all applicable rail systems;

1: 10 x 25 mm

2: 10 x 30 mm

- Easy to clean
- Light in weight
- Fix hose or QC hose connection
- Spring activated
- Ergonomic shape
- Metal gas inlet and outlet
- Gas remains in metal
- All gas types are available
- Wall slide possibility
- All regional standards are available
- NIST connectors to fix modular hoses in all gas types
- Fulfills the Ambulance standards

### MOUNTING OF CLAMP

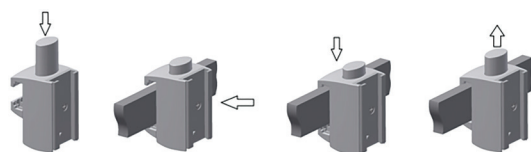

# MediClamp



MediEject with DIN probe



MediEject with fixed clamp



T-slide clamp with MediEject

## FIXED CLAMPS ON RAILS



MediMeter with fixed clamp on rail



MediFlow Ultra II with fixed clamp on rail



Gas Control Equipment

GCE world-wide: <http://www.gcegroup.com>